

# **INNOVASUB**

## **DPX-1 SHIELD DPX-3 DAGGER**



## **USER MANUAL**

Thank you for your purchase of Innovasub equipment. Please read this instruction manual completely before attempting to operate or dive with this product.

# Table of Contents

- 1. Housing.....1
- 2. Precautions.....2
- 3. Installing a Tablet to the Housing.....2
- 4. Cautions when Removing.....4
- 5. Using with DPX-3 Dagger.....4
- 6. Optionals.....5
  - 6.1 Vacuum Pump System.....5
  - 6.2 Humidity Sensor.....6
  - 6.3 Ball Mounts.....6
- 7. Specifications.....7
  - 7.1 DPX-1 Shield.....7
  - 7.2 DPX-3 Dagger.....7
- 8. Housing Care & Maintenance.....8
- 9. Troubleshooting.....9
- 7. Technical Support.....9
- 8. Limited Warranty.....10
- 9. Recommended Accessories.....11

# Copyright Notice

This documentation is protected by copyright law and international treaties. The manual is licensed, and its use is subject to a License Agreement. Unauthorized use, copying or distribution of the manual or any of its components may result in severe criminal or civil penalties and will be prosecuted to the maximum extent under the law.

# 1. Housing

- A- O-Ring
- B- Handles
- C- Lock Mechanism
- D- Rotation Mechanism
- E- Frame
- F- Glass
- G- Shell
- H- Cap
- I- Viewport

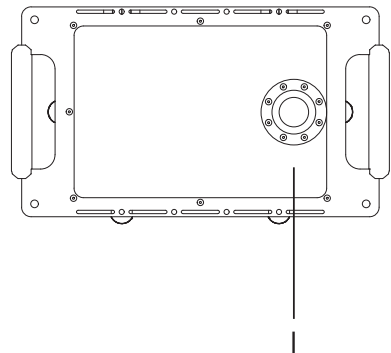
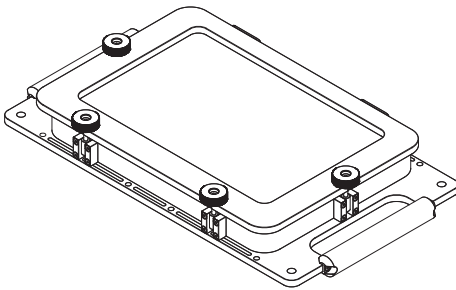
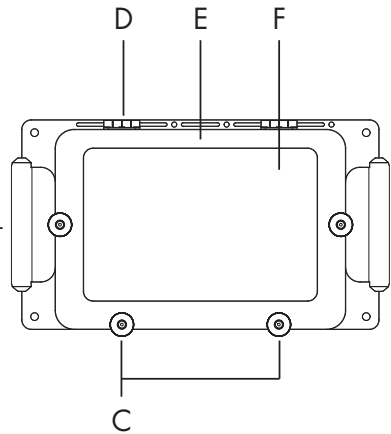
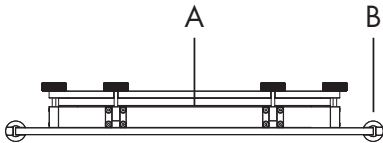
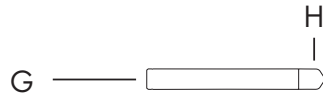

## 2. Precautions

This product has been water pressure tested at the factory and is depth rated to 60m. Thoroughly inspect and immerse the empty housing completely in water before installing the tablet. If any fogging occurs or droplets of water enter the housing, don't install the tablet. Clean the housing main o-ring and retest to make sure that it is watertight.

- Do not open the housing when wet.
- Do not unscrew the lock mechanism screws of the housing.
- Make sure to not insert any water inside the housing.
- Protect the housing from drops and vibrations.
- Protect the housing from high sources of heat.
- Do not leave the tablet inside the housing when not in use.

## 3. Installing a Tablet to the Housing

Turn on the tablet screen and change auto lock duration to maximum. Unscrew the locking mechanisms to open up the glass cover.

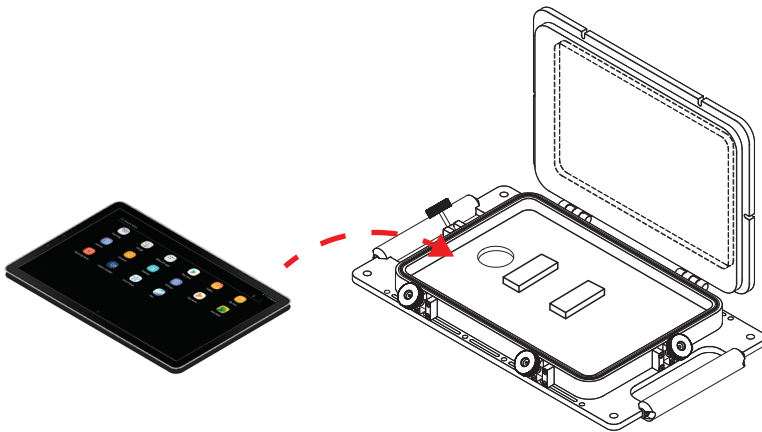

Check the O-Ring if it is solid and on position.

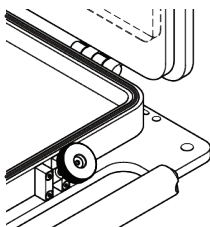

**Attention!**

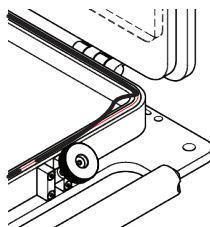

Center the tablet on foams.

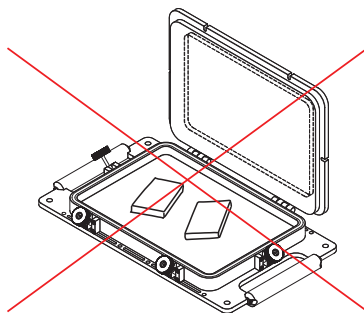

Close the cover and screw the locking mechanisms.

**! Over tightening the screws can cause damage to the housing.**



**Attention!**

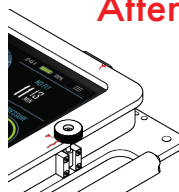



## 6. Optionals

### 6.1 Vacuum Pump System

Turn the vacuum alarm protective cap on counter clockwise and press the button and the red flash at this time.



Connect the vacuum pump handle to the vacuum alarm, pull the handle to vacuum until the indicator turns green. Cover the protective cap.

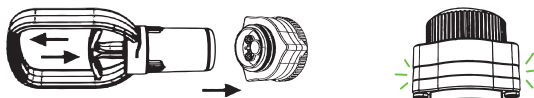

After finish dive, open the vacuum alarm protective cap and press the button to release the vacuum. Press the button for about 3 seconds to turn off the power supply.



## 6.2 Humidity Sensor

If the water gets into the housing, the red light will turn on and the alarm will start to sound.

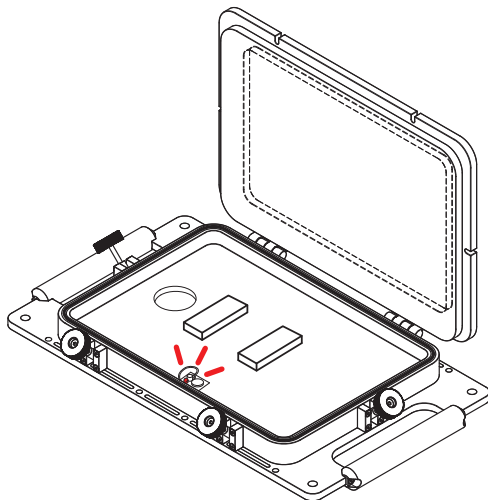

## 6.3 Ball Mounts

You can attach your flashlights and action cameras easily to the housing by the ball mounts on the back.

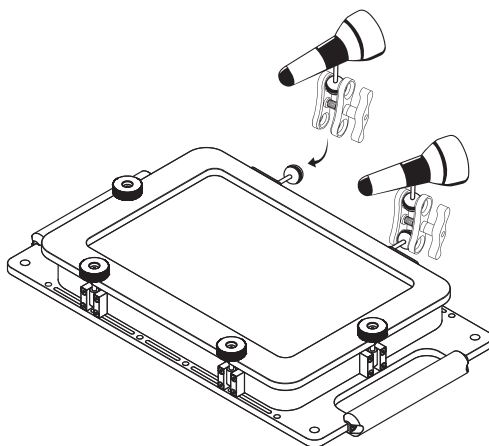



## 7. Specifications

### 7.1 DPX-1 Shield

- Width .....375 mm
- Height .....220 mm
- Depth .....55 mm
- Weight .....3380 g
- Buoyancy .....Negative
- Depth Rating .....60 m
- Materials.....Anodized Aluminum, Acrylic, Tempered Glass, Rubber

### 7.2 DPX-3 Dagger

- Width .....20 mm
- Height .....172 mm
- Depth .....20 mm
- Weight .....50 g
- Buoyancy .....Positive
- Depth Rating .....60 m / 196 feet
- Materials.....Delrin

## 8. Housing Care & Maintenance

### After the Dive

As you may know, salt water is highly corrosive. Even though your housing is manufactured by a material that is not affected by salt water, it can be compromised when left exposed to salt water for extended periods of time.

- When you finished diving, completely submerge your housing immediately into fresh water or wash it. If you cannot do so directly, then as soon as possible after the dive.
  - If you don't plan to open the housing between dives, then there is no need to remove the housing from the fresh water prior to your next dive.
  - If you open the housing between dives, thoroughly dry the housing before opening.
  - Do Not leave the tablet and housing in direct sunlight for prolonged periods. Heat may damage the tablet.
  - Do Not ship the tablet in the housing.
  - Before using the housing, always check the tightness of each lock mechanism.
  - Keep the O-ring clean and lightly lubricated. To lubricate, remove the O-ring. Put a small amount of lubricant on your fingers. Pull the o-ring through your fingers to apply a light coating of lubricant. Only apply enough lubricant to make the O-ring feel slick. Do Not stretch the O-ring. This light coating of lubricant will help to keep the O-ring from drying out and will help to show a dark sealing line when the housing back is properly sealed.
  - Keep the area where the o-ring fits and the sealing surface clean.
- CAUTION: Never use spray lubricants as the propellant ingredient can cause housing to crack.

## 9. Troubleshooting

Water enters the housing

- Remove, clean and properly lubricate the main housing and o-rings.
- Look for hairs, dirt, or foreign debris crossing the o-ring seal.
- Return housing to Innovasub for maintenance.

Problem with Pen's sensitivity

- Be sure using compatible tablets. Only works with inductive touch screens.
- Be sure pen touch mode is enabled.

!! The pen is positioned and its sensitivity adjusted gently. Do not open the cap.

## 10. Technical Support

Please read the troubleshooting section of this instruction manual before contacting Technical Support for help, or returning product.

Information contained in this instruction manual is subject to change at any time without prior notice.

Innovasub Technical Support

Email: [info@innovasub.com](mailto:info@innovasub.com)

Phone +90 216 337 9559

Fax +90 216 330 2115

# 8. Warranty

This product is warranted against any manufacturing defects for a period of one (1) year from the original date of purchase. Defective products should be returned with postage paid. Innovasub will, at its sole discretion, repair or replace such products, and will return to customer postage paid. All other claims of any nature are not covered. Except as mentioned above, no other warranty expressed or implied applies to this product.

9. Accessories

9.1 DPX-2 Dive Computer Software

(Requires DPX-5 Rigel - Pressure Sensor Module)

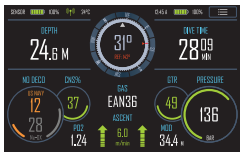

Dive Screen



Dive Graph



DPX-5 Rigel

9.2 DPX-46 Messaging and Navigation Software

(Requires DPX-9 Meissa - Acoustic Modem)



Messaging



Navigation



DPX-9 Meissa

9.3 DPX-7 Seafalcon - Tablet Carrier



Side View



Front View



Full Equipment

Via Puglie n. 76  
64026 Roseto degli Abruzzi (Te)

**innovasub.com**